



Pacific Hoists

QUALITY LIFTING SOLUTIONS

INSTRUCTION MANUAL

Pacific Load Skates



IMPORTANT

Please read this instruction manual before using these products.

This manual contains important information regarding safety, operation, installation & maintenance. ALWAYS operate, inspect and maintain these products in accordance to the relevant Australian Standards.

INTRODUCTION

Thank you for purchasing your new Pacific Load Skates. Pacific Hoists' policy is to constantly strive to improve quality, safety and environmental standards. Our commitment remains as always, to supply the largest range and the best quality products available. Pacific Hoists are constantly seeking new and improved products to provide the right solution for an ever widening range of applications.

Pacific Hoists have been supplying Load Skates to the Australasian Materials Handling market for over 15 years. These low profile load movers are designed to facilitate the moving, positioning or installation of a wide range of loads including heavy equipment, machinery and bridge structures.

All users of this Pacific Load Skate should read this manual in full and understand the safe operating principles of the device.

SPECIFICATIONS TABLE

MODEL	LSK005	LSK010	LSK020	LSK030	LSK050	LSK075
Capacity per 4 units (tonne)	5	10	20	30	50	75
Unit length (mm)	A	190	206	228	228	292
Unit width (mm)	B	99	99	99	99	145
Unit height (mm)	C	65	65	65	65	97
Unit track width (mm)	D	55	55	55	55	100
Unit roller diameter (mm)	E	20	20	20	20	30
Unit no. of rollers	F	12	14	16	16	14
Unit rollers in contact		4	5	6	6	6
Unit weight (kg)		4.3	4.9	5.6	5.6	17.5
Unit height with turntable (mm)		100	100	100	100	145
Unit turntable top diameter (mm)		100	100	100	100	143

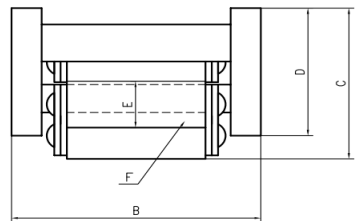
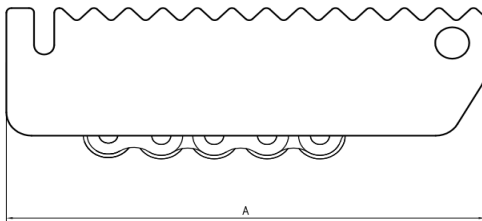

Placement of Load Skates

- Place your skates carefully under the heaviest part of the load.
- Weight should be distributed evenly across all four skates.
- Skates should be evenly loaded. If necessary, use a wooden contact block to ensure that the weight is spread across both sides of the skate.
- It is recommended the skates are placed so that they are easily accessible.

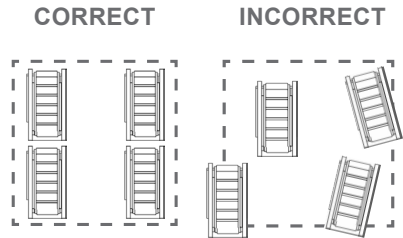

Alignment of load skates

- It is very important to make sure the skates are aligned with the direction of travel. Failure to do so may destroy the skates.

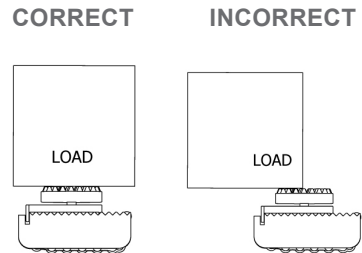

Use of optional turntable

- When using turntables it is necessary to make sure the skates are parallel and that the turntable top is fully under the load.
- Make sure to place the turntable with the locating plate in the groove of the skate.

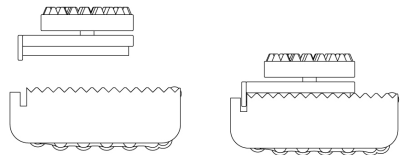

Surface Conditions

- Heavily loaded skates should be run on a metal surface such as a steel track as they will damage a concrete floor.
- The area should be swept clean of any dirt, sand or small objects such as stones or nails.
- When moving up or down an incline, the skate should be attached to the load.
- Load skates cannot be used to move a load across an incline. If a load has to be taken across an incline, the surface should be built to ensure the skate and load are horizontal.

CAPACITY - OPERATIONAL & MAXIMUM LOAD

The load that a set of load skates can carry depends on the surface conditions. Refer to the following table to determine the load that the skates can carry.

MODEL	LSK005	LSK010	LSK020	LSK030	LSK050	LSK075	SURFACE CONDITIONS
Operational Load per set of four skates (tonne)	5	10	20	30	50	75	Excellent - Flat, heavy duty concrete in good condition overlaid with steel. Skate lubricated.
	3	7	14	20	35	50	Good - Commercial reinforced concrete.
	1	4	10	15	25	30	Poor - Cast concrete panels, dished or dirty surface.
Maximum Load per one skate (tonne)	1.25	2.5	5	7.5	12.5	18.75	Ideal - Flat level smooth surface, clean environment with minimal dust/ dirt. Known load distribution evenly over skate/s. Perfectly aligned skates to the direction of motion. Constant supervision of load movement. Secure load to prevent side persuasion. Skates are lubricated.

MAINTENANCE

- When the skate is assembled it is lightly oiled. Before operating the unit it is recommended the inside of the body be greased, so that damage caused by out of parallel skates is minimised.
- After use it is recommended the load skate be lightly washed in kerosene to remove the dirt and contaminated grease, the unit should be re-oiled once it has dried.

Pacific Hoists is not responsible for any damage or injury caused by incorrect use of the Pacific Load Skates.



WARRANTY

Pacific Hoists Pty Ltd (ABN 88 000 631 032) warrants that all products distributed by the company are guaranteed against any apparent fault arising from manufacturing defects caused by faulty materials and / or workmanship.

Should any part fail due to the above within the specified period listed in the product warranty table, Pacific Hoists Pty Ltd will repair or replace the defective part free of charge. To make a claim pursuant to this warranty, the equipment must be delivered to Pacific Hoists Pty Ltd. Freight charges both ways are payable by the claimant and no liability is accepted for loss or damage during transit. The claimant is required to produce the original invoice or other purchase documents as proof of purchase when making a claim pursuant to this warranty.

The warranty does not cover the purchaser or any other person for damage, loss, normal wear or faults caused from misuse or incorrect installation of the equipment.

To be eligible under this warranty, the equipment is required to have been installed and operated correctly by qualified personnel and has not been subject to abuse, neglect or adjustment carried out by an unauthorized person.

This warranty may only be varied with the written approval of the Directors of Pacific Hoists Pty Ltd.

In the following statement 'Our' means 'Pacific Hoists Pty Ltd' and 'You' means the 'claimant.'

Our goods come with guarantees that cannot be excluded under the Australian Consumer Law. You are entitled to a replacement or refund for a major failure and for compensation for any other reasonably foreseeable loss or damage. You are also entitled to have the goods repaired or replaced if the goods fail to be of acceptable quality and the failure does not amount to a major failure.

The benefits given to the claimant in this warranty are in addition to other rights and remedies under a law in relation to the goods or services to which this warranty applies.



PRODUCT	WARRANTY PERIOD
Hitachi Electric Chain Hoists	12 months
Pacific Electric Chain Hoists	12 months
Pacific Hydraulic Hoists	12 months
JDN Air Hoists	12 months
Vital Chain & Lever Blocks	12 months
Pacific Chain & Lever Blocks	12 months
Pacific Trolleys	12 months
CrosbyIP Lifting Clamps	12 months
Electrical Feed Systems	12 months
Pacific Jib Cranes	12 months
Pacific Magnetic Lifters	12 months
Comeup Electric Winches	12 months
Comeup Hydraulic Winches	12 months
Pacific Hand Winches	12 months
Pacific Porta Lift Trolleys	12 months
Pacific Electric Lifters	12 months
Pacific Scissor Trolleys	12 months
Pacific Lifter Trolleys	12 months
Pacific Platform Trolleys	12 months
Pacific Load Skates & Rollers	12 months
Kromer Spring Balancers	12 months
Safepour	12 months
DrumGrab	12 months
Pacific Pallet Trucks	24 months
PH Hydraulic Pumps & Accessories	24 months
Pacific Clamps	60 months
Eagle Pro Hydraulics	Lifetime



INSPECTION & SERVICE LOG

DATE	NOTES	SIGNATURE

Imported and distributed by Pacific Hoists Pty Ltd via a national distributor network throughout Australia and New Zealand.

For further information in relation to this product, please contact the distributor outlet where the product was purchased.

HEAD OFFICE

24 Foundry Road Seven Hills NSW 2147

| P +61 2 8825 6900 | F +61 2 8825 6999 | E sales@pacifichoists.com.au

WESTERN AUSTRALIA

Unit 1, 31 Colin Jamieson Drive Welshpool WA 6106

| P +61 8 6253 1000 | F +61 8 9458 9840 | E sales@pacifichoists.com.au

NEW ZEALAND

11 Druces Road Wiri Auckland NZ 2104

| P +64 9 263 5566 | F + 64 9 263 5567 | E sales@pacifichoists.co.nz

